

P:\PROJECTS\SA2341\_400 Sunset Drive Pompano Beach FL 33062\_Ali Nazem\Working Drawings\CD\2341\_A\100\_LS-10\_Life Safety Plan.dwg

PUBLIC SAFETY SECURITY PLAN KEYNOTES

- 01 CAMERAS LOCATED AT EACH ORNER OF THE BUILDING. ELECTRONIC SURVEILLANCE.
- 02 BALCONIES AND WINDOWS ABOVE TO OVERLOOK THE STREETS AND THE SURROUNDING. NATURAL SURVEILLANCE.
- 03 COMMON WALKWAY TO ACCESS TO EACH UNIT. NATURAL ACCESS CONTROL.
- 04 ACCESS TO EACH GARAGE FROM THE SUNSET DRIVE. NATURAL ACCESS CONTROL.
- 05 PROPOSED FENCE WITH SIGN SHOWING THAT THIS IS NOT ACCESS TO THE PROPERTY. NATURAL ACCESS CONTROL.
- 06 LANDSCAPE DESIGN INCLUDES TREES AND SHRUBS TO IMPROVE THE SAFETY OF THE PROPERTY. TERRITORIAL ENFORCEMENT.
- 07 FENCE WITH SIGN "NO TRESPASSING". TERRITORIAL ENFORCEMENT.
- 08 PROPOSED LANDSCAPE TO KEEP THE VALUE OF THE PROPERTY AND SHALL BE WELL MAINTAINED. MAINTENANCE.
- 09 THE TRASH CAN SHALL BE AT THE GARAGE, GO OUT FROM THIS SPACE AND BACK AGAIN TO THE GARAGE TO KEEP THE EXTERIOR AREA CLEAN AND IN A GOOD CONDITION. MAINTENANCE.

GENERAL NOTES

SUNSET DRIVE  
50' RIGHT OF WAY

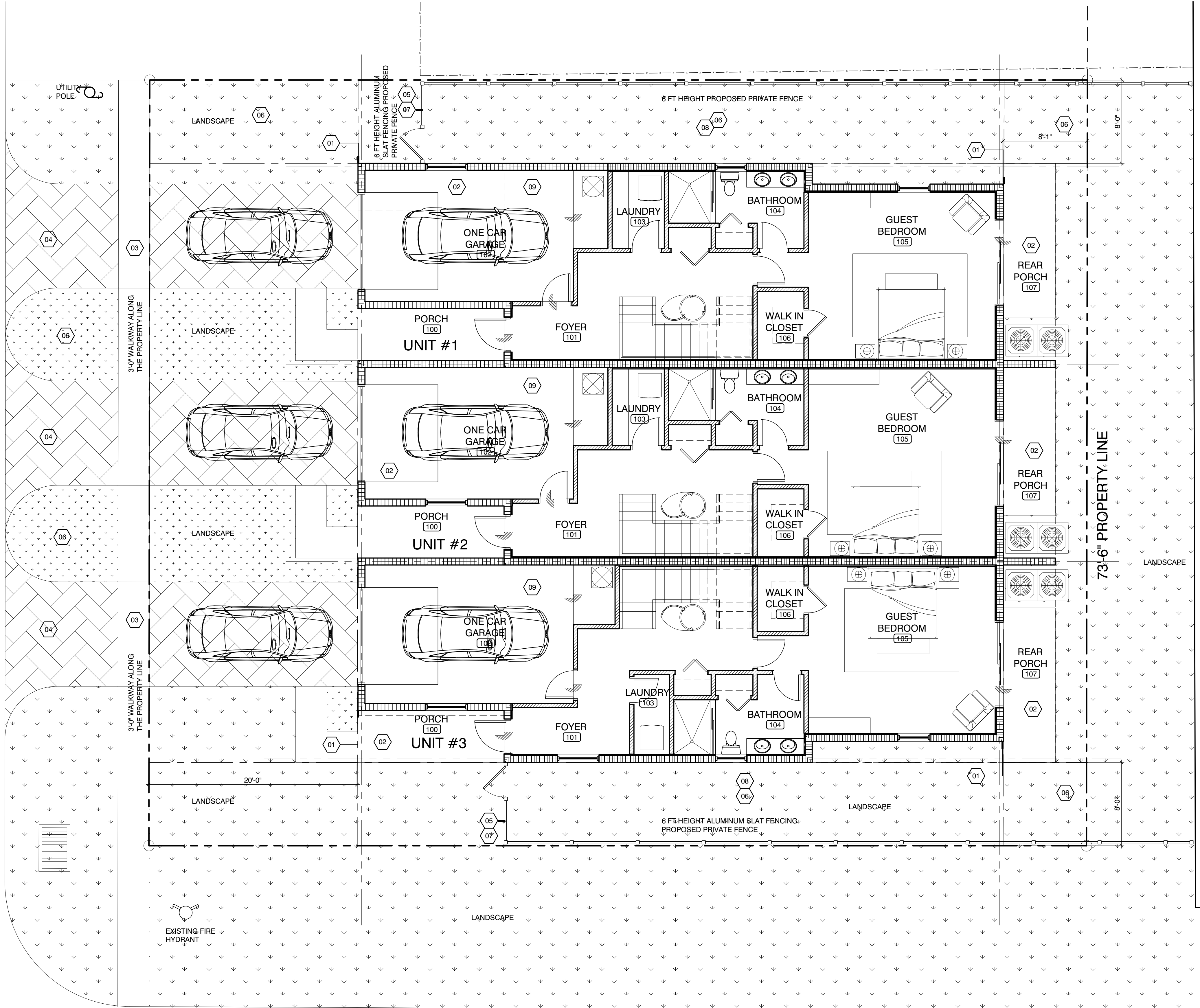

NORTHEAST 4th STREET  
50' RIGHT OF WAY



PUBLIC SAFETY SECURITY PLAN

SCALE  
3/16" = 1'-0"

01 004 PS-1.0

PZ24-12000007  
04/17/2024

NEW TOWNHOUSES AT:  
400 SUNSET DRIVE,  
POMPAÑO BEACH, FL 33062

REVISIONS DATES:

PROFESSIONAL SEAL

Richard H Simon  
Digitally signed by Richard H Simon  
Date: 2024.03.15 15:58:30 -04'00'

RICHARD HARRIS SIMON #A80014364  
REGISTERED ARCHITECT STATE OF FLORIDA

ISSUE DATE: 02/19/2024  
PROJECT #: 2341 AN 100  
DRAWN BY: NMGE  
CHECKED BY: RHS

PUBLIC  
SAFETY  
SECURITY  
PLAN

514 N.E. 9th Avenue  
Pompano Beach, FL 33060  
P: 954.566.7298 F: 954.566.3286  
www.simonarchitectural.com  
AA-C000582  
architects - interior designers  
engineers - construction managers

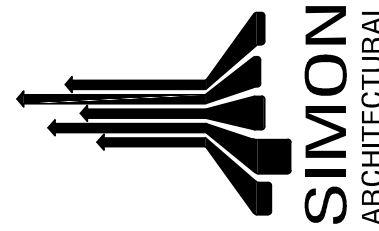

© Simon Architectural PA  
THIS DOCUMENT IS THE PROPERTY OF  
SIMON ARCHITECTURAL PA AND SHALL NOT BE  
REPRODUCED WITHOUT THE WRITTEN CONSENT  
OF SIMON ARCHITECTURAL PA.

PROJECT